

# AVAILABLE FOR LEASE

*122 E. Market Street  
Greensboro, North Carolina*

**NEW  
REDUCED  
RATE**

For more information:

Drew Showfety, CCIM  
mobile: (336) 253-6386  
dshowfety@emersonprop.com

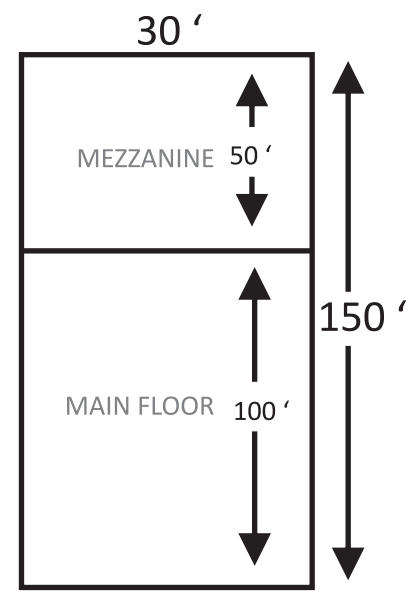
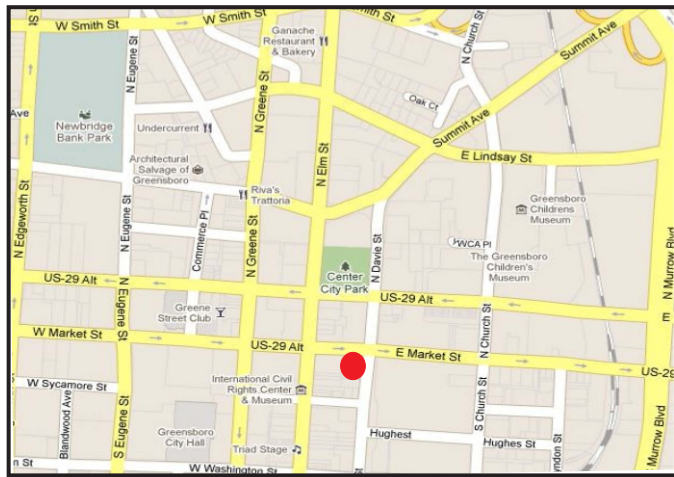

- 4,500 +/- sf in the heart of downtown Greensboro located at the corner of Davie and E. Market Street
- Approx. 12,000 vehicles per day
- Creative office or retail space
- Convenient parking

**\$12.00 sf**

**Emerson Commercial Properties, LLC**  
819 N. Elm Street  
Greensboro, NC 27401  
office: (336) 478-4441  
fax: (336) 478-4442  
www.emersonprop.com

The information contained herein was obtained from sources believed reliable. Emerson Commercial Properties, LLC makes no guarantees, warranties, or representations as to the completeness or accuracy contained herein. The presentation of this property is submitted subject to errors, omissions, changes of price or conditions prior to lease or withdrawal without notice.